

## MEET YOUR FIRE TV SOUNDBAR PLUS

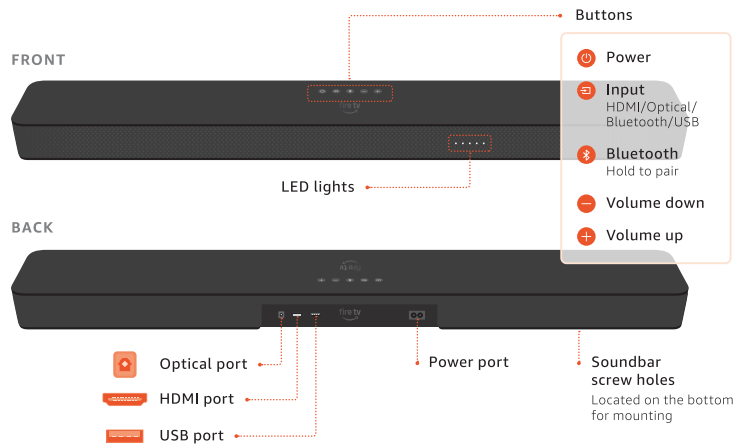

## MEET YOUR REMOTE



## ALSO INCLUDED

### High Speed HDMI cable



### Use this cable for the best experience

If connecting to a Fire TV, you can adjust the soundbar's settings in the Fire TV Settings menu.



Power cord



2 AAA batteries



**Soundbar wall mounting accessories**  
See the mounting instructions

## POSITIONING THE SOUNDBAR

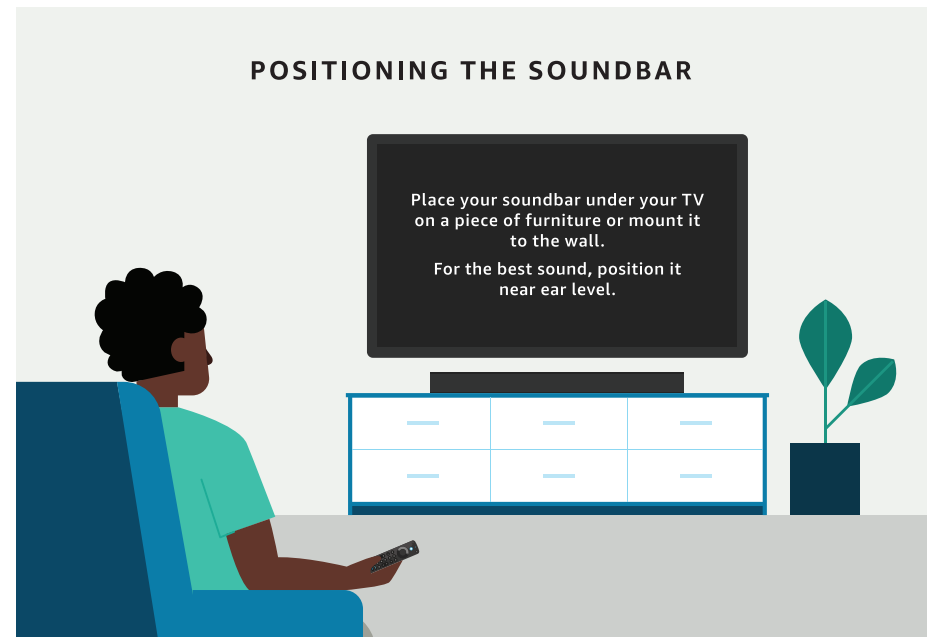

## CONNECT TO YOUR TV WITH HDMI

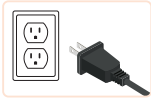

### 1. Plug in the power cord

Plug the included power cord into your soundbar's power port and then a power outlet.

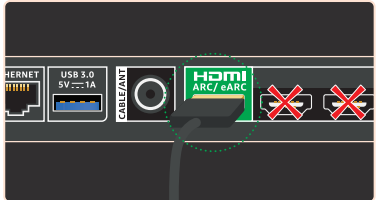

### 2. Plug the HDMI cable into your TV's HDMI ARC/eARC port

- Find your TV's ARC/eARC port. Plug the included HDMI cable into it.
- Plug the other end into your soundbar's HDMI port.
- Check that your TV's HDMI CEC setting is enabled.

**Important:** Only your TV's HDMI ARC/eARC port will work with the soundbar.



### 3. Select soundbar's HDMI input

Press the input button (Ⓜ) on the soundbar or the soundbar remote until the HDMI option is selected.

## OTHER TV CONNECTION OPTIONS



### OPTICAL

Use if your TV doesn't have an HDMI ARC/eARC port. Dolby Atmos and DTS:X aren't supported.

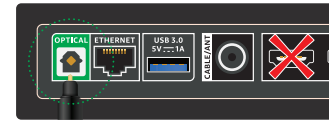

1. Plug an optical cable\* into your TV's and soundbar's optical ports.  
*\*Optical cable sold separately.*

2. If using a Fire TV, go to the Settings and select Equipment Control > Manage Equipment > Amazon Fire TV Soundbar to finish setup.



### BLUETOOTH

HDMI or optical cables must be unplugged to use. Dolby Atmos and DTS:X aren't supported.



1. Press and hold the Bluetooth button on the soundbar or remote until the LED blinks blue in discovery mode.
2. In the TV's Bluetooth settings, select Fire TV Soundbar Plus.

## SOUNDBAR LED LIGHTS

### Bass minimum

One white light on the left



### Dialogue minimum

One white light on the left



### Bass maximum

Five white lights



### Dialogue maximum

Five white lights



### Treble minimum

One white light on the left



### Mute

Five white lights stay on



### Treble maximum

Five white lights



### Bluetooth ready to pair

One flashing blue light



### DTS TruVolume on

Five white lights turn on



### Bluetooth paired

One blue light



### DTS TruVolume off

Three white lights turn on



### Surround Effect on

Five white lights turn on starting with the middle light



### Dolby Digital or DTS playback

One green light flashes once



### Surround Effect off

Five white lights turn off starting with the outside lights



### Dolby Atmos or DTS:X playback

Three green lights flash once



## SOUNDBAR AUDIO SETTINGS



### Equalizer

EQ modes are customized sound settings for different content: Movie, Music, Sports, and Night mode.



### Bass

Adjusts the low frequency sounds from levels 1 to 9.



### Treble

Adjusts the high frequency sounds from levels 1 to 9.



### Surround Effect

Provides immersive, multi-dimensional sound experience.



### Dialogue Enhancer

Increases the clarity of voices from levels 1 to 5.

### DTS TruVolume

Long press the Dialogue Enhancer button to turn on. Automatically adjusts volume levels for different content and apps on your smart TV.

## SOUNDBAR WALL MOUNTING ACCESSORIES

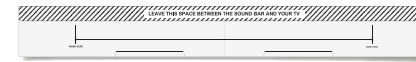

Paper wall mounting template  
Sized to the device

Wall screw hole  
Soundbar screw hole



2 anchors



2 wall screws



2 soundbar screws

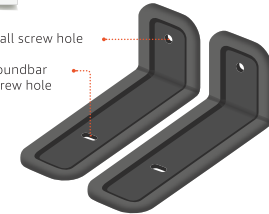

2 brackets

**Note:** Included screws and anchors are recommended for drywall. If using the anchors, do not drill into studs.

## MOUNTING THE SOUNDBAR ON THE WALL

### Tools you'll need

Not included in the box



Electric drill  
• 5/16" (or 8 mm)  
drill bit  
• Phillips #2 driver bit



Hammer



Level or level app



Wall-safe tape

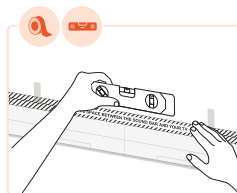

### 1. Level and tape the paper template to the wall

Using a level or level app, position and tape the template to the wall under your TV.

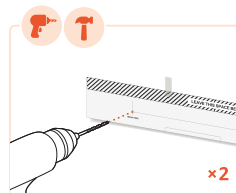

### 2. Drill holes and install anchors

If you're using the anchors, drill holes where the template says **MARK HERE**.

After drilling both holes, remove the template and tap the anchors into the holes with a hammer.

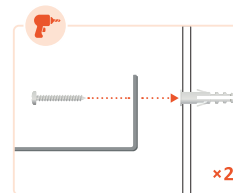

### 3. Attach the brackets to the wall

Insert the included wall screws into the brackets' wall screw holes.

Screw the wall screws into the anchors until the brackets are firmly attached.

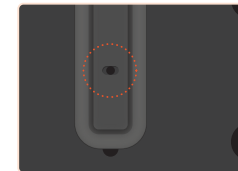

### 4. Position the soundbar on the brackets

Carefully line up the soundbar screw holes on the brackets and the bottom of the soundbar.

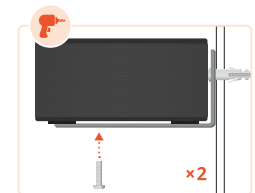

### 5. Attach the soundbar to the brackets

Screw the soundbar screws into the bracket's and soundbar's soundbar screw holes until secure.

**Warning:** Do not drill into wiring or piping.



### **Help and accessible information**

Scan the QR code or visit:

[amazon.com/setup/firetvsoundbarplus](https://amazon.com/setup/firetvsoundbarplus)