

# Hisense

10K  
BTU

PORTABLE AIR CONDITIONER

up to 300 sq.ft.

Model: AP10CR2W



- Low Noise Cooling System
- Precise Temperature Control with I-Feel
- Powerful Cross-flow Fan Design
- Cooling, Fan, and Dehumidifier functions
- Remote Control is included



#### Quiet Operation

With an ultra-quiet compressor, and a new, cross-flow fan design, airflow is both strong and quiet, achieving just 47 dB(A) with the fan set on "Low".



#### Convenient Dual Display

A second, front-facing Temperature display is easy to read, even from across the room.



#### I-FEEL Remote Control

The I-FEEL temperature sensor built into the remote control senses its surrounding temperature, and transmits the signal back to the unit, providing maximum comfort.



#### Warranty

90 Day Parts & Labor.

## Cool Comfort - Quiet, Convenient, and Easy to Install

The Hisense AP10CR2W Portable Air Conditioner provides the utmost in performance more conveniently than ever. Airflow is strong, cool and quiet due to the new cross-flow fan design. Additionally, the louvers automatically open to a pre-set position after the unit is powered on. To adjust the automatic louver, press SWING once. Press SWING again to hold the louver at a desired direction. Also, a second, front-facing temperature display makes it easy to see the temperature from across the room. Preserve the external appearance of your home with the included, easy to install window kit, for windows 18" to 50" wide. This Hisense portable air conditioner cools, dehumidifies, and can function in fan mode.

### TECHNICAL SPECIFICATIONS

Performance	
Hisense-Model	AP10CR2W
Cooling Capacity (BTU)	10,000 BTU (ASHRAE-128-2001)
Heating Capacity	N/A
Maximum Cooling space	300 sq. ft.
Refrigerant	R-410A
Noise Level in dB(A)	47 - 49 dB(A)
Electrical	
Voltage / Freq / Amps	115V/60Hz / 10.4A
Control Features	
Unit Control Type	Electronic
Fan Control	Button
Thermostat Control	61 - 86 °F
Display Type	Dual LED
Sleep Mode	Yes (on remote)
Dry Mode	Yes
Smart Mode	Yes (on remote)
Cooling Speeds	3 speeds
Temp Display Units	°C / °F
Clock	Yes (on remote)
Timer	24 Hr
Auto Restart	Yes
General Features	
Removable Filter	Yes
Washable PP Filter	Yes
Motorized Air Swing	Yes (on remote)
Vent System	Single Hose, 5.9"D x 59"L
Dehumidification	2.25 Pints / hr
Airflow (CFM)	185 - 230
Accessories	
Remote Control	Yes
AA Batteries	Yes - included
Air Hose	Yes
Window Kit	Yes
Approvals	
Safety	ETL
Energy	CEC
Parcel Shippable	No
Shipping	
Unit Dimension WxDxH (mm)	442x318x714

Carton Dimension WxDXH (mm)	498x386x885
Net Weight /Gross Weight (Kg)	29.2/31.9
Unit Dimension WxDxH (inch)	17.4x12.5x28.1
Carton Dimension WxDXH (inch)	19.6x15.3x34.9
Net Weight /Gross Weight (lbs)	64.4/70.9
Loading(40HQ)	425
Loading (53')	468 (floor loaded)
Warranty/UPC	
Parts & Labor	90 Day
UPC	

### Dual Display

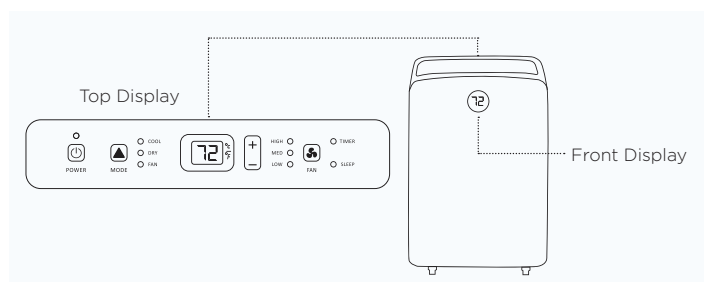

### Window Size

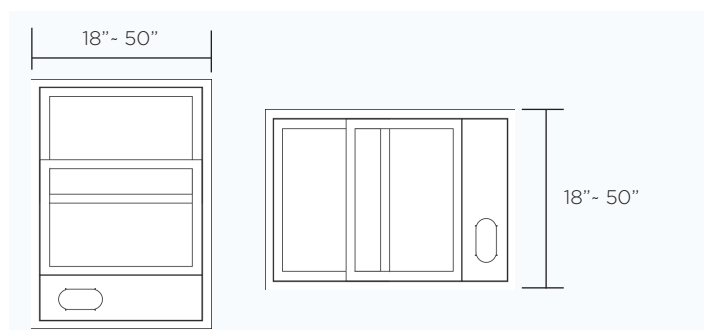

The window installation kit allows you to install the air conditioner in most vertical-sliding windows 18" to 50" wide, or horizontal-sliding windows from 18" to 50" high.

All product, product specifications, and data are subject to change without notice to improve reliability, function, design or otherwise. ©2017 Hisense USA, All rights reserved

Hisense USA Corporation  
7310 McGinnis Ferry Road, Suwanee, GA, 30024  
1-877-465-3566  
www.hisense-usa.com

