

### More Tips for Better TV Reception and More Channels

1. Rescan for channels regularly (highly recommended).
2. Experiment with different antenna locations in your house.
3. Face the antenna towards the TV broadcast towers.
4. Use a longer coaxial cable to reach the window facing the broadcast tower if needed.
5. When living near mountains, tall trees or tall buildings, lay the antenna flat on a table or other surface.
6. Place the antenna as high as possible.
7. Use the amplifier when needed to boost reception.
8. Eliminate Interference from electronics and electric equipment.

### Tweaking the Antenna Position

Try placing the antenna in or near a window facing the broadcast tower.

For big houses, avoid mounting locations that might be obscured by large trees, a shed or garage or other large obstructions. Try a few different positions to find the best location.

Note: ALWAYS rescan channels after EVERY move of the antenna, no matter how small.

### Factors May Impact Reception

1. Too long of a coaxial cable
2. Metal near or around windows
3. Low E-glass windows
4. Electronics and electric equipment near the antenna
5. High wind
6. LED lights
7. Proximity to major freeways
8. Proximity to airports
9. Terrain obstructions such as hills, mountain, trees, buildings,etc.

### Warranty

#### 30-Day Guaranteed Refund

All 1byone products are eligible for a refund for any reason within 30 days of purchase.

Please contact 1byone customer service and you will receive refund information within 48 hours.

#### 90-Day Replacement/Refund for Quality-Related Issues

1byone products can be replaced or refunded within 90 days of purchase for quality-related issues or breakdowns not caused by improper use or improper maintenance.

#### 24-Month Warranty for Quality-Related Issue

1byone products that break within 24 months due to normal, proper use, can be replaced at no cost.

Please NOTE: Product damage caused by improper use or improper maintenance is not covered by warranty.

United States

Tel: +1 909-391-3888 (Mon-Fri 9:00am-6:00pm PST)

Email: [ushelp@1byone.com](mailto:ushelp@1byone.com)

Unite Kingdom

Tel:+44 158 241 2681 (Mon-Fri 9:00am-6:00pm UTC)

Email: [ukwebhelp@1byone.com](mailto:ukwebhelp@1byone.com)

German/France/Italy/Spain

Email: [euhelp@1byone.com](mailto:euhelp@1byone.com)

Japan

Email: [jphelp@1byone.com](mailto:jphelp@1byone.com)

#### 1byone Products Inc.

1230 E Belmont Street, Ontario, CA 91761

Customer Service: +1 909-391-3888

[www.1byone.com](http://www.1byone.com)



## Remote Control 360° Rotation VHF & UHF Infrared TV Antenna

SKU 6-202NA-001



**Congratulations!** You have just purchased the finest, technologically advanced, easy-to-install HD digital antenna for outdoor use. **1byone**® products have been rated “best sellers.” We hope your investment in this quality antenna will give you and your family years of enjoyment. Thank you for your purchase and your support. We invite you to visit our website at [www.1byone.com](http://www.1byone.com) for other high-quality products.

### Package Content

Antenna Unit

39.37ft Coaxial Cable

Detachable Rotor with Pole Mounting Accessories

Power Supply Unit (PSU)

Remote Control (batteries not included)

5ft 3C2V Coaxial Cable (From PSU to TV)

Cable Ties x 3

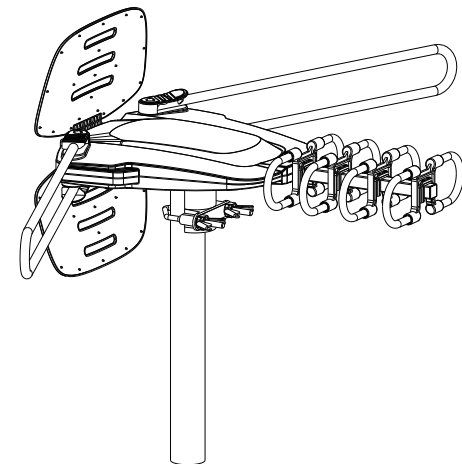

[www.1byone.com](http://www.1byone.com)

Specification

Frequency Range	Channels	Impedance	No. of Elements	Antenna Gain	Amplifier Gain	Beam Width H/V	Front-Back Ratio	Antenna Length
170-230MHz 470-862MHz	Ch.5-12 Ch.21-69	75 Ω	6	3-5dBi 7-10dBi	15dBi	H60°/V60° H360°/V360°	15-20dBi	440mm

How To Install

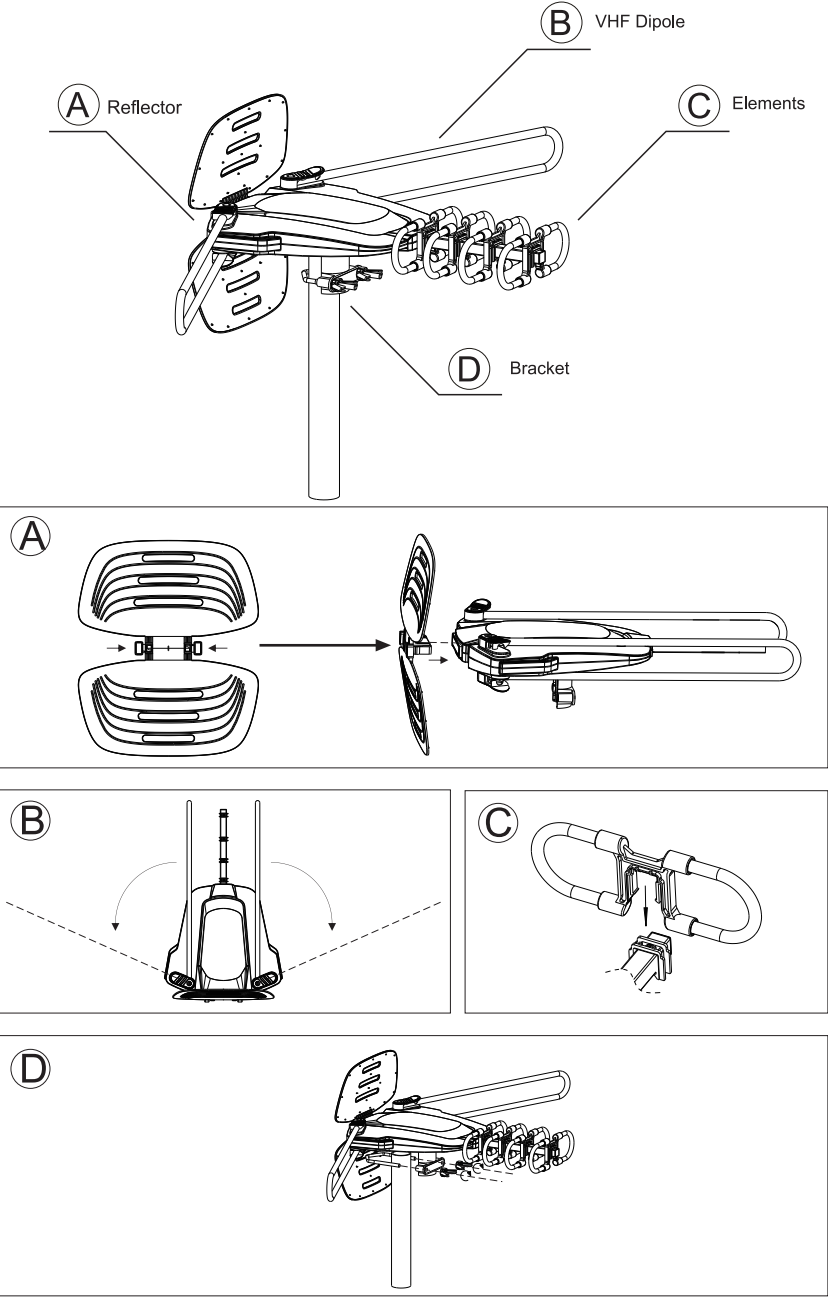

**Step 1:** Insert the Reflector parts into the main unit of antenna. (Refer to graph A)

**Step 2:** Unfold the VHF Dipole until they stay in horizontal orientation. (Refer to graph B)

**Step 3:** Install the Elements parts on the main unit of antenna. (Refer to graph C)

**Step 4:** Connect the weather-proof F connector to the dipole box. Tighten the F connector and protect it with the weather-proof cover.

**Step 5:** Mount the antenna to the pole with the connecting part as high as possible and point the antenna towards the TV tower for the best reception. Then connect the other end of the coaxial cable to the F connector on the PSU marked “IN”. (Refer to graph D)

Please reserve a certain length of cable in case it is pulled due to rotation.

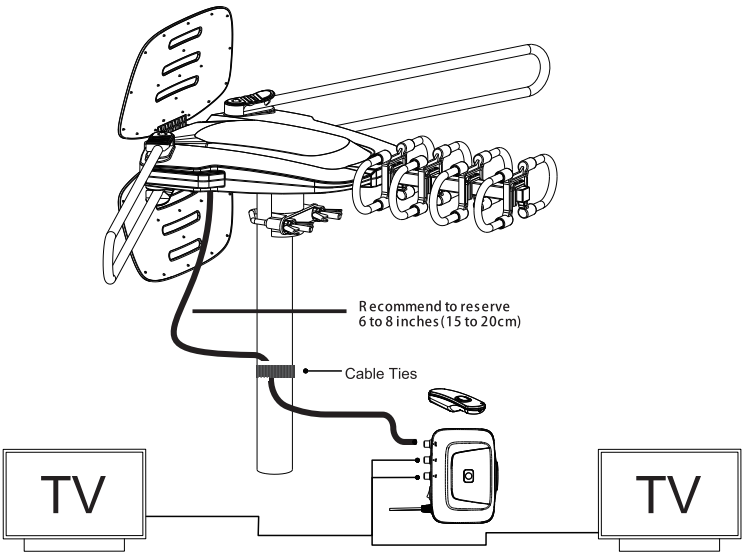

**Step 6:** Connect the port on the PSU marked “TV” to the antenna input on your set-top box or HDTV using the included 1.5-meter 3C2V Coaxial Cable.

**Step 7:** Plug the PSU into a socket, turn on your TV and run a channel scan. If you’re not receiving all your local channels, you can adjust the direction of the antenna by long-pressing the remote control or the push button on the power supply unit. The antenna can complete a full 360° rotation and the motor can turn in both directions to avoid tangling lines.

Note:

1. The antenna will rotate when you keeping pressing the button on the remote control or power supply unit. If you stop pressing or press just for a few seconds, the antenna will not rotate.
2. Remember to do a channel scan every time you change the antenna’s direction.
3. There is no battery included in the remote control. Please insert the correct battery type.

Preparing to connect the TV antenna

- 1.Check your TV’s type.  
Smart TVs and HDTVs can connect to the antenna directly. A digital converter box may be needed for TVs made prior to 2009. Please provide your own box if needed.
- 2.Find the location of your local broadcast towers to find the best mounting position for your antenna. Check your house’s reception using the following websites:  
FCC: [www.fcc.gov/media/engineering/dtvmaps](http://www.fcc.gov/media/engineering/dtvmaps)  
TV Fool: [www.tvfool.com/](http://www.tvfool.com/)  
Antenna Web: [antennaweb.org/address](http://antennaweb.org/address)

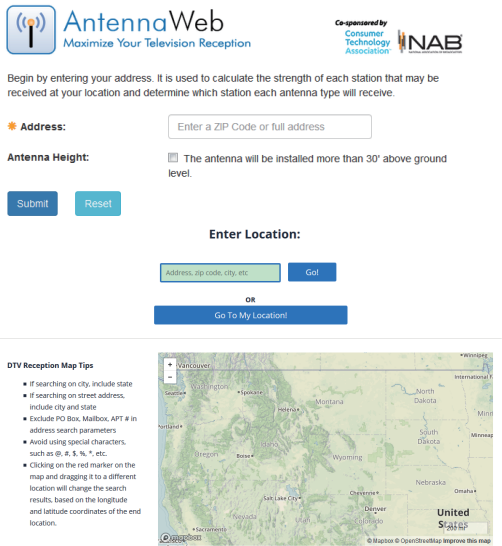

After connecting the antenna to the TV, use the TV remote control to scan for channels.

Here are generic steps to run a channel scan:

- 1.Run the “Scan” function on your TV by pressing the Menu button on the remote control and find “Scan” or “Setup.”  
Make sure the TV is set to “Air” or “Antenna” instead of “Cable”
- 2.Below is a basic channel scan menu for your reference. Please remember that different televisions have different setup processes.

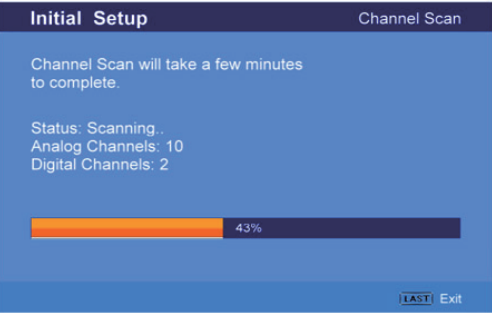

- 3.You will receive digital signals through that antenna once the scan is complete.  
Consult your TV’s manual or ask the manufacturer if you do not know how to access the channel scan function.

Note: Rescan for channels periodically, especially if you performed the initial scan on a cloudy day or during inclement weather as you might get some new stations you couldn’t pick up during bad weather.