



Extra Strong Expandable Garden Hose 50Ft

Got a question? Have a problem?



CUSTOMER SERVICE:

Scan me to Email us



Email us: support@tbi-pro.com

Scan me to Text us



Text us: +1 800-674-9229

Just Scan the QR Code with your iPhone or Android Camera to get in touch with us.

THE COMPLETE GUIDE TO GARDEN HOSE FITTINGS

The hose is a modern hose that automatically extends up to three times compared to its initial length when the water is in the ON position and automatically shrinks back to its "relaxed" length when the water is in the OFF position. The weight of the hose is rather light. This will allow avoiding dirty work when using heavy bulky ordinary hoses.

Package content

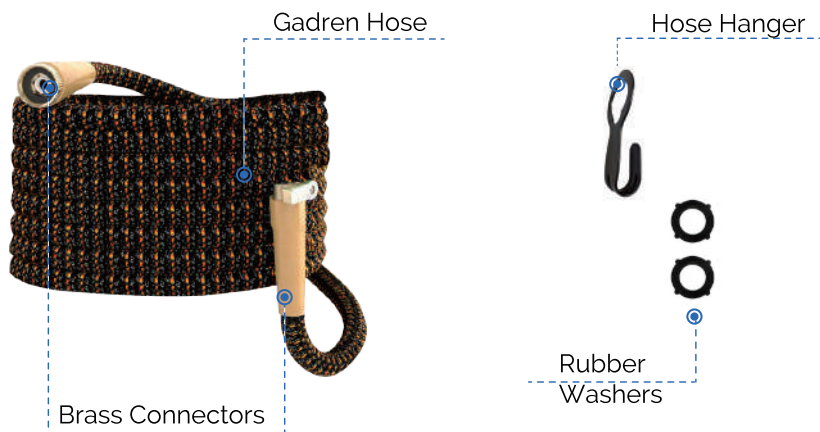

Using the hose

1. The rubber washer should be firmly placed inside the female coupling before using the hose to prevent the water leaking.

During the first time hose using first fill and extend the hose, then slightly stretch it to free from the tightness in the outer bent material covering.

Then pour the water out of the hose, refill it and use normally.

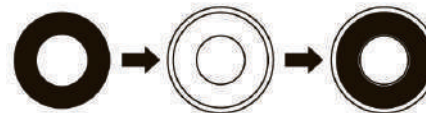

2. Fasten the female end of the hose to the source spigot.

3. Fasten the ON/OFF valve to the hose male.

4. Turn the ON/OFF valve OFF.

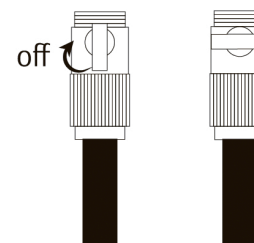

5. Turn the water ON at the source. Enhance the water pressure gradually. The hose will automatically extend up to three times compared to its original length.

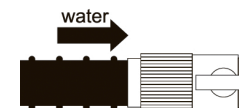
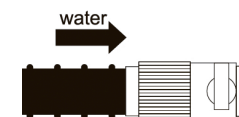
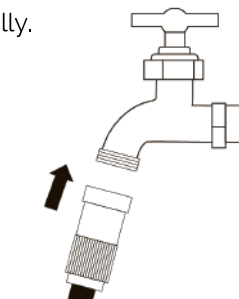

6. Turn the ON/OFF valve ON after the hose is fully extended. The hose can now be used as an ordinary hose.

7. Turn the water OFF at the spigot after you stop using the hose.

8. Turn the ON/OFF valve ON so that the water in the hose could dry up. In a case of a nozzle usage, open it. After the water in the hose begins draining, the hose will automatically shrink to its initial length.

The hose is designed for routine irrigation use!

- ✓ Hot water is prohibited to be run through the hose.
- ✓ Do not leave the open water and the hose under the water pressure when not in use.
- ✓ In the summer period the hose should be drained when not in use and kept in a shadow place.

- ✓ Protect the hose from the cold by storing it indoors. Drain the hose entirely before keeping it as the remaining water in the hose may freeze causing the hose damage.

Instructions for using the hose with a sprayer

1. Turn the ON/OFF valve at the hose end to the OFF option.
2. Open the water at the source. The hose will expand in length. During the first time hose using first fill and extend the hose, then lightly expand it to free it from the tightness in the outer bent material covering. Then pour the water out of the hose, refill it and use normally.
3. Fasten the sprayer to the ON/OFF valve.
4. Put the sprayer in the place you wish somewhere in the garden or yard.
5. Direct the sprayer nozzle away from your face and turn the ON/OFF valve to the ON position. Walk away. The sprayer will work just the same it works with the ordinary hoses.

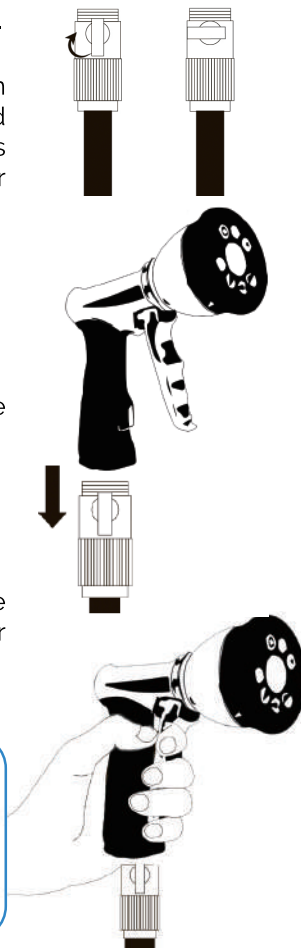

If the sprayer is not fastened to the ground (in case of an oscillating sprayer) and the water is turned OFF, the sprayer may be dragged some distance as the hose shrinks to its initial length. This action should not harm either the hose or the sprayer.

FAQ

- Q What is minimum pressure?
- It is 2.5 kg.
- Q What is maximum pressure?
- It is 12.5 kg.

- Q What is inner diameter of the hose?
- The inner diameter is 6*9.5 mm.
- Q Shutoff valve does not turn. What should I do?
- Please, change the connector.
- Q Does this hose snag when stretched over bricks or rough pavement?
- No, it doesn't.
- Q Can you use the hose without a nozzle?
- No, it can't be stretched without nozzle.
- Q Is it OK to use with hot water?
- No. Please, don't use it with hot water.
- Q Can this be connected to a pressure washer as the water source?
- No, it cannot be connected.
- Q Does water have to be on for shutoff valve to work?
- No.
- Q Can you buy 2 and connect together for extra length? What kind of connectors would you need?
- Yes! You need to buy the same threaded connector.
- Q What is the weight of 50ft, 100ft hose?
- The weight of 50ft is 1.6 kg, and the weight of 100ft is 2.4 kg.
- Q How many layers of latex are in the core of this hose?
- There are 9 layers in the core of this hose.
- Q Can a car run over hose without destroying it?
- Yes, it can.
- Q What is its burst psi?
- It is 12.5 kg.
- Q Can I leave the hose attached to the wall faucet?
- No, you can't.



If you have any questions,
contact us at any time via email:
support@tbi-pro.com