

# WORKUP

## INSTALLATION / OWNERS MANUAL

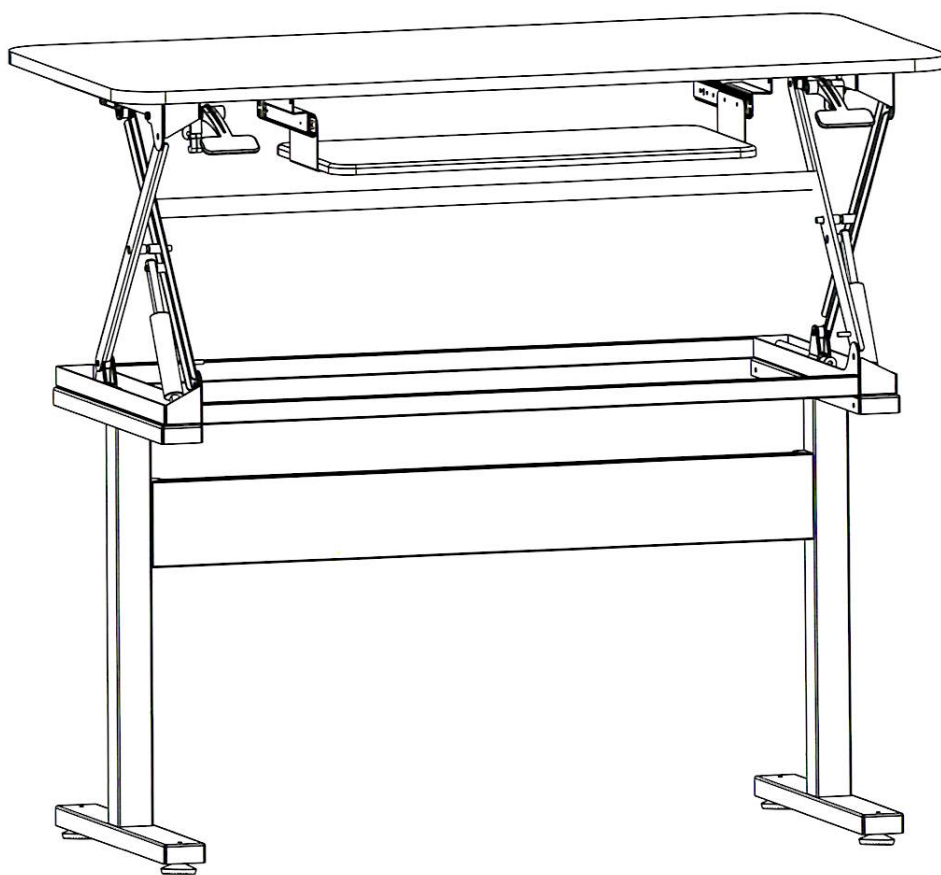

**MODEL: XAFD-M3**

**NEED HELP? CONTACT US:** Monday – Friday, 9 am – 5 pm  
PST **657-341-0362** or Email us: **cs@scsources.com**

WorkUP  
Supply Chain Sources LLC.,  
339 N Berry St., Brea, CA 92821  
scsources.com  
657-341-0362



## INFORMATION

**NEED HELP? CONTACT US:** Monday – Friday, 9 am – 5 pm PST  
657-341-0362 or Email us: [cs@scsources.com](mailto:cs@scsources.com)



Do not fully tighten screws until completely assembled.



Place desk on a level surface during operation, installation, and assembly.

## TOOLS YOU MAY USE (NOT REQUIRED) - 2 PERSON RECOMMENDED



Drill

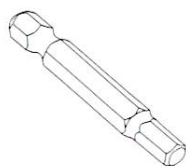

Allen Bit

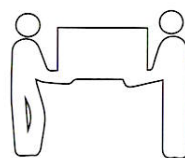

2x persons

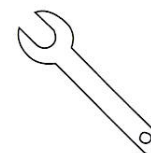

Wrench

## PARTS / HARDWARE

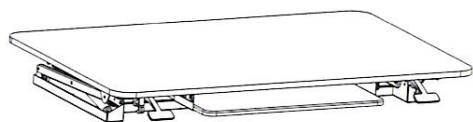

1. Desk Body



2. Desk Feet x2

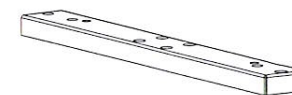

3. Desk Foot Brace x2



Screwdriver



G x 8  
(M8 x16)



H x 16  
(M6 x16)

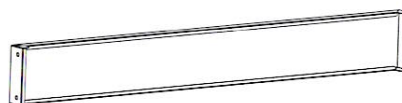

4. Desk Brace

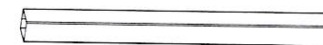

5. Desk Pole x2

# STEP 1

## Desk Feet Assembly

Carefully stand up and align each **DESK POLE** with the **DESK FEET** pre-drilled screw holes facing each other.

Secure using the provided screwdriver and (H) screws **4x** on each side.

Align the **DESK POLE** and **DESK FOOT BRACE** pre-drilled screw holes facing each other.

Secure using the provided screwdriver and (H) screws **4x** on each side.



Screwdriver



H x 16  
(M6 x 16)

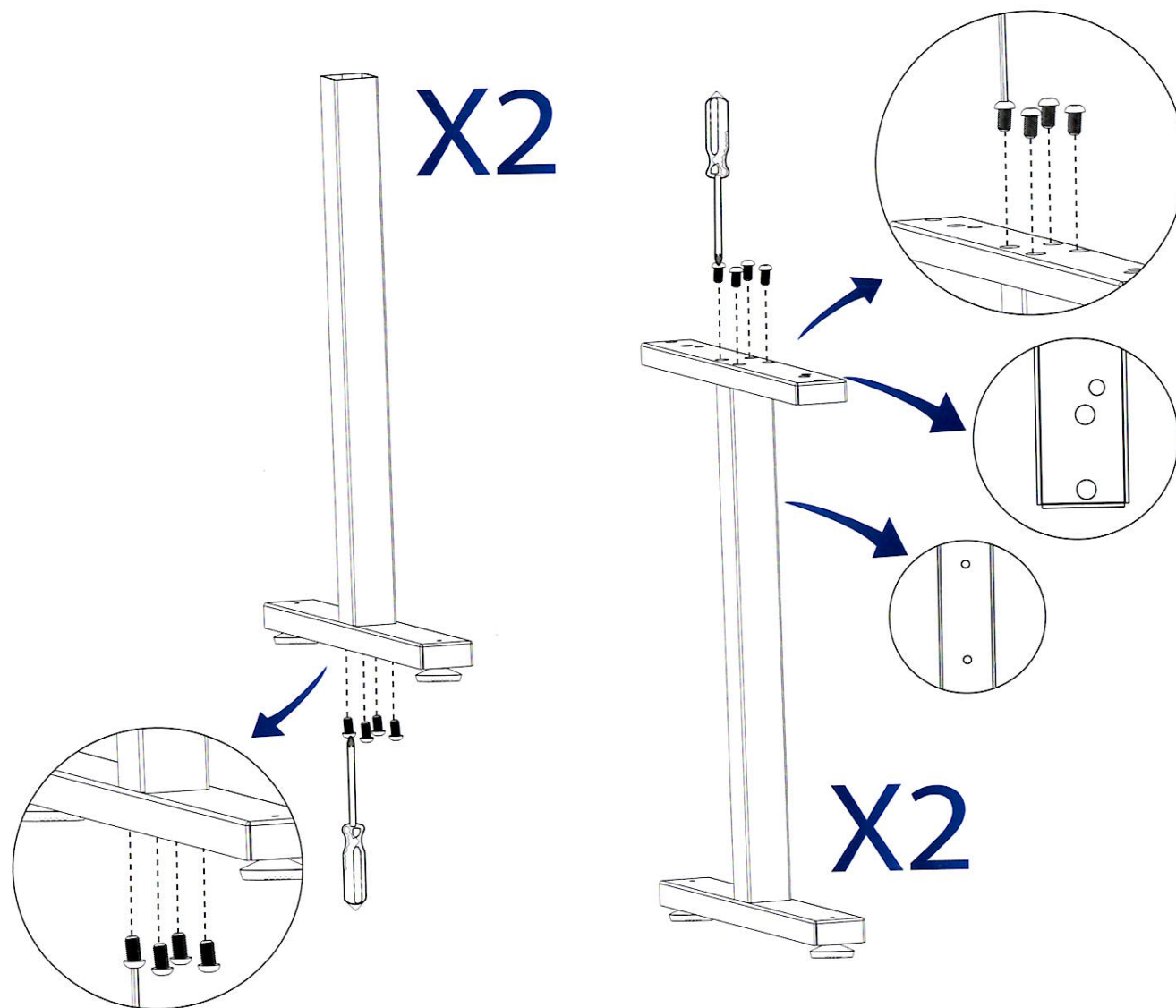



## STEP 2

### Desk Body Assembly

Align the **DESK BODY** with the previously assembled **DESK FEET**

Make sure the **DESK BODY** is raised to allow access to the pre-drilled holes.

Secure on each side using the provided screwdriver and (G) screws **2x** on each side.

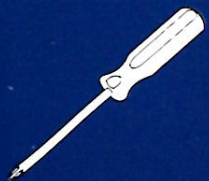

Screwdriver



G x 4  
(M8 x 16)

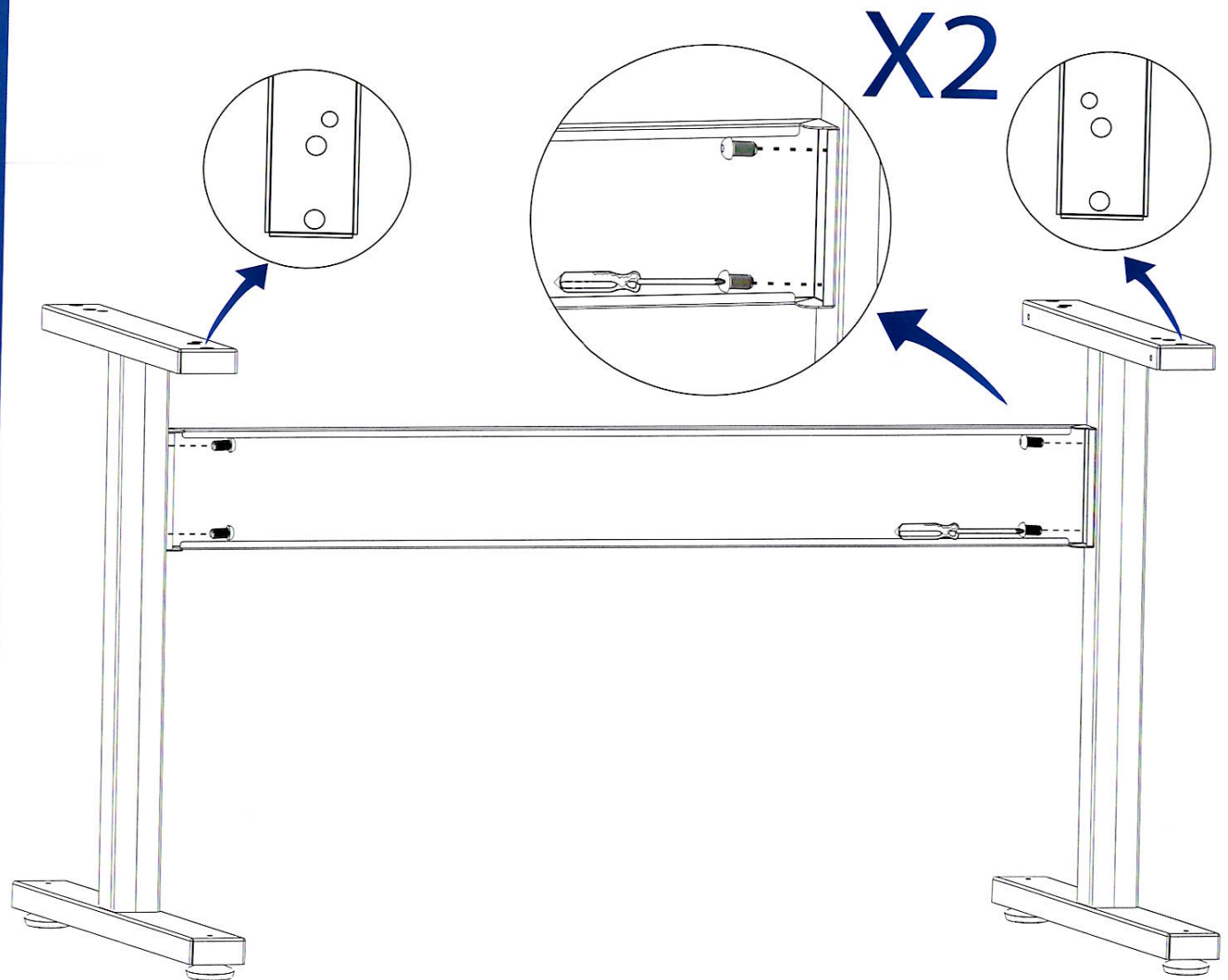

## STEP 3

### Desk Body Assembly

Align the **DESK BODY** with the previously assembled **DESK FEET**

Make sure the **DESK BODY** is raised to allow access to the pre-drilled holes.

Secure on each side using the provided screwdriver and (G) screws **2x** on each side.



Screwdriver



G x 4  
(M8 x 16)

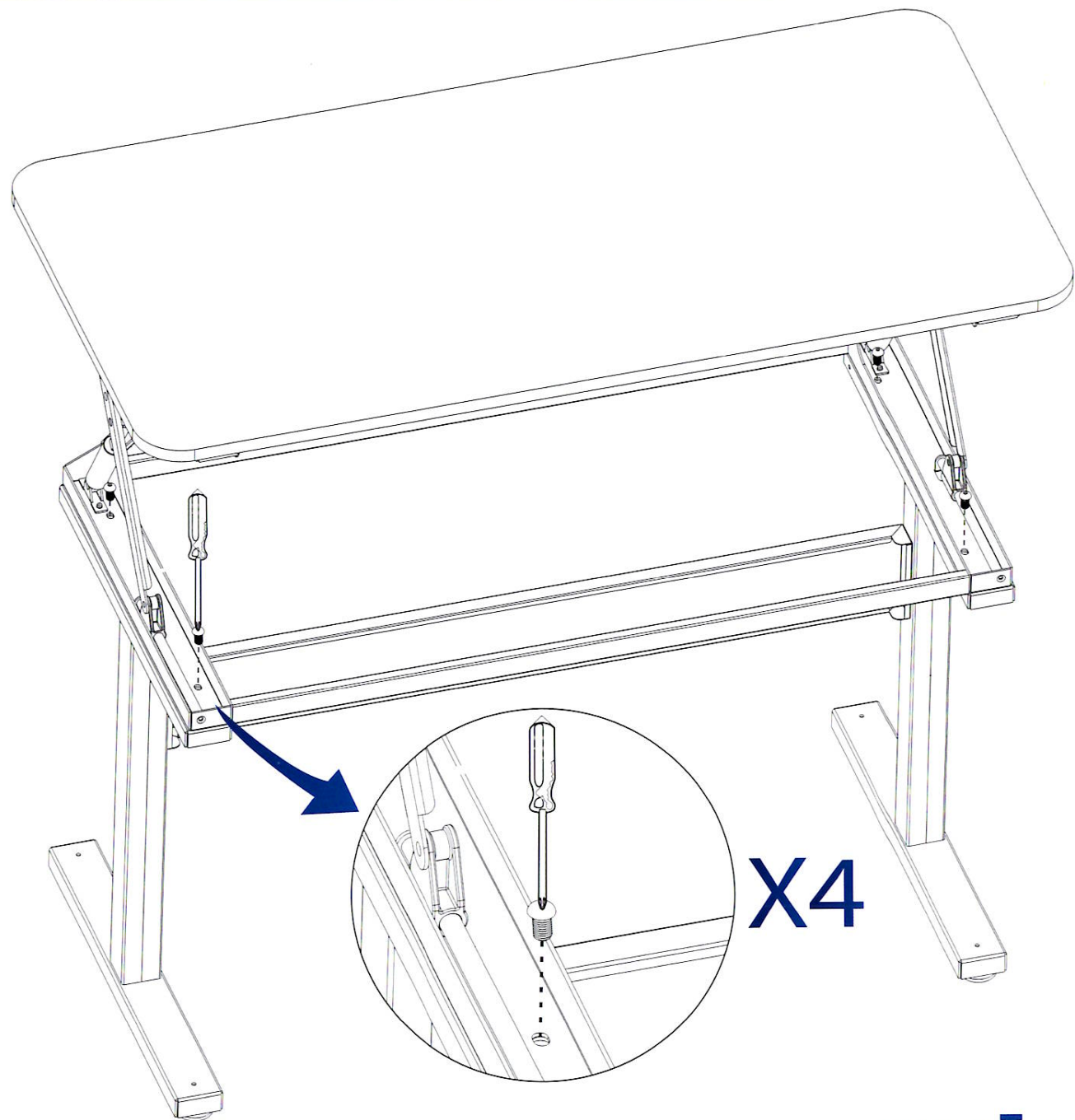

**NEED HELP? CONTACT US:** Monday – Friday, 9 am – 5 pm  
PST **657-341-0362** or Email us: **cs@scsources.com**

WorkUP  
Supply Chain Sources LLC.,  
339 N Berry St., Brea, CA 92821  
scsources.com  
657-341-0362