

# GETTING STARTED. Setting up your Neato.

1

**IMPORTANT!** Remove the protective film from Neato's screen and charge base. If the films are left on, the robot may not be able to see your home or find its charge base.

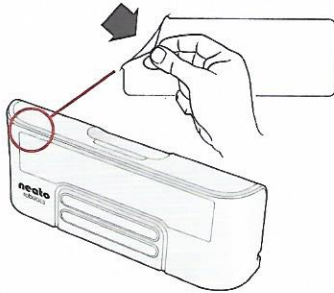
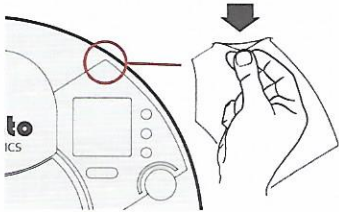

2

Please follow battery connection instructions included with your Neato Robot Vacuum.

3

Choose a wall outlet that has a 3' (1 m) clearance on both sides and in front of the charge base. This helps your robot find the charge base.

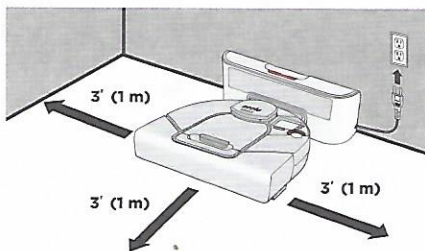

Plug in the power cord and push the charge base against the wall. Place the rounded side of your Neato against the metal contacts on the charge base.

4

Find your language using arrows to the right of the screen.

Press **SELECT** button under the screen to choose a language.



5

## CHARGING AND OPTIMIZING THE BATTERY

- Before using, charge your Neato overnight – about 12 hours.
- **IMPORTANT!** To get the most from your battery, charge it and discharge it completely two to three times.
- Always put your Neato back on its charge base when you are finished cleaning.



### Status Lights

#### **SOLID GREEN**

Fully charged and ready to clean.

#### **BLINKING GREEN**

Charging, battery not fully charged, can clean.

#### **BLINKING AMBER**

Charging, can't clean yet.

#### **SOLID AMBER**

Error, see message on screen.